

Document Title:	Test Report	 we test your mobile apps ■
Document ID:	AU0001.000001.212	

Application Under Test	Linphone
Software Build ID #	2.1.2
Order Date	18-Jul-2013
Package	Effective Scan
Included Testing	Build Acceptance, Exploration, Negative, User Interface, Compatibility, System
Test Execution Date	23-Jul-2013
Target Device	Samsung Galaxy S3 (I-9300)
Operating System	Android 4.1.2

Defects that were found during each type of testing

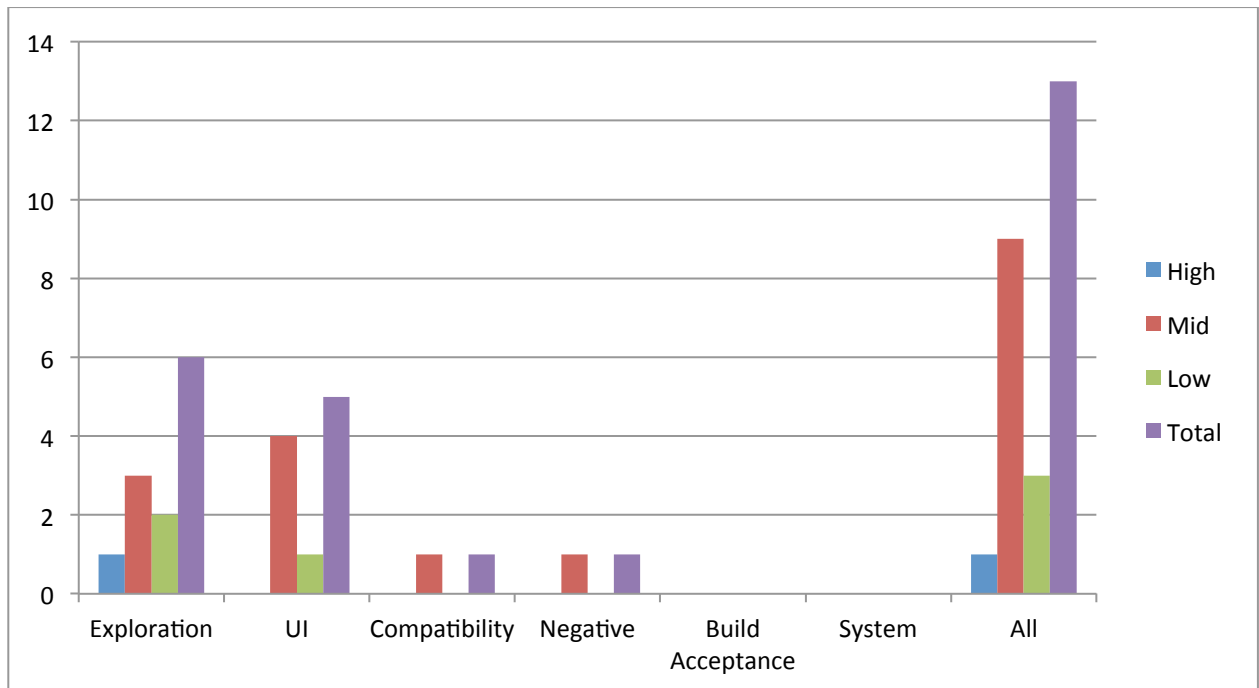

Conclusion

High importance

System Violation issue - application crashed unexpectedly twice, but it's not possible to reproduce;
 User Interface defect - Samsung Touch Wizz UI was not considered. Its Multi-window menu element overlaps functional "Send Message" button.

Middle importance

Usability defects - most of instructions are wrong, which may cause user confusion.

Advice

High importance items should be fixed obviously - high risk of app rejecting by Google Play Market and other application stores.

Middle important defects confuse users, which may cause negative feedbacks from users.

Document Title:	Test Report	TestLab4apps <small>we test your mobile apps ■</small>
Document ID:	AU0001.000001.212	

#	Description	Result	Evidence
---	-------------	--------	----------

Table 1 Exploration Testing

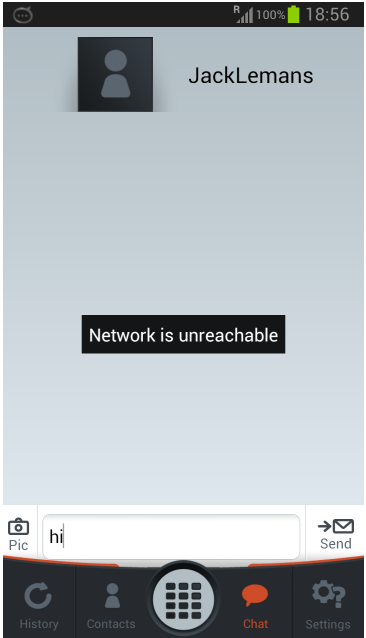
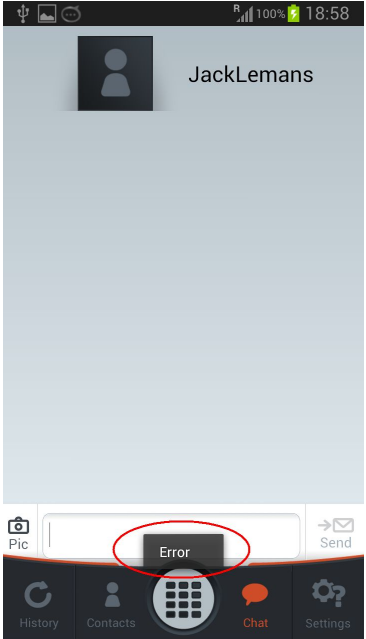
11	Verify that error messages in the application are clearly understandable when Wi-Fi service is turned off during chat with the user.	Passed	<p>EXPL-001-i9300</p> 
12	Verify that error messages clearly explain to a user the nature of the problem and indicate the action to be taken when Wi-Fi service is turned off and "Pic" button is pressed to upload image from the device.	Failed	<p>EXPL-002-i9300</p> <p style="color: red;">Actual result: "Error" notification is shown to the user.</p> <p style="color: red;">Expected result: "Network is unreachable" notification is shown to the user.</p> 
13	Verify that any function selected in the application starts within 5 seconds.	Passed	
14	Verify that circle progress bar appears during credentials verification process on first login.	Passed	

Document Title:	Test Report	TestLab4apps we test your mobile apps ■
Document ID:	AU0001.000001.212	

15	Verify that mandatory fields are marked with an asterisk and warning is generated, if the Domain data is left blank.	<p>Failed</p> <p>Actual result: "Please enter your login and password" notification is shown to the user.</p> <p>Expected result: "Please enter domain" notification is shown to the user.</p>	<p>EXPL-005-i9300</p>
16	Verify that only valid data can be filled in by entering "George Biglestone" in the Username field.	<p>Failed</p> <p>Actual notification: "Your username is not valid" notification is shown to the user.</p> <p>Expected notification: "Only alphanumeric characters are acceptable" notification is shown to indicate that space symbol is not allowed in username.</p>	<p>EXPL-004-i9300</p>
17	Verify that users are notified about unsaved changes in "New contact" screen upon switching to another (Chat) screen.	<p>Failed</p> <p>Actual result: The notification is missed.</p> <p>Expected result: "Exit without saving?" notification is shown to the user.</p>	
18	Verify that screen rotations are performed correctly for particular view: - all buttons are displayed; - text and graphic elements are visible.	N/A Phone version of application supports the portrait mode only.	
19	Verify that "Back" button takes user back to previous screen (clicking on "Back" button on home page should move application to background).	Passed	

Document Title:	Test Report	TestLab4apps we test your mobile apps ■
Document ID:	AU0001.000001.212	

20	Verify "Home" button switches application to background and moves user to the main desktop.	Passed	
----	---------------------------------------------------------------------------------------------	--------	--

Table 2 User Interface Testing

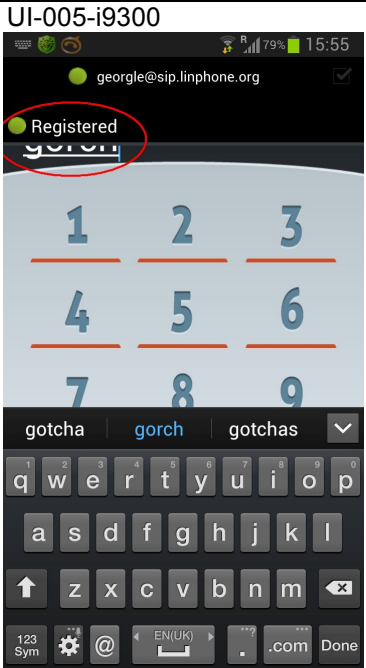
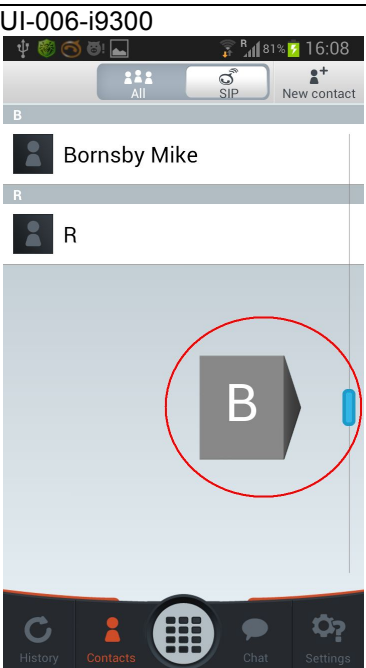
54	Verify that UI elements alignment is proper.	Passed	
55	Verify that opened status bar on the top of application doesn't overlap entry filed.	<p style="color: red;">Failed</p> <p style="color: red;">Actual result: Status bar overlaps input field.</p> <p style="color: red;">Expected result: Status bar does not overlap input field.</p>	 <p>UI-005-i9300</p>
56	Verify that application logo is not blurred or cut.	Passed	
57	Verify that the width of data entered does not exceed the width of the fields on the screens with text boxes.	Passed	
58	Verify that screen scrolling is performed with no visual issues.	<p style="color: red;">Failed</p> <p style="color: red;">Actual result: The scroll bar is shown when list of users does not exceed screen height.</p> <p style="color: red;">Expected result: The scroll bar is not shown when list of users does not exceed screen height.</p>	 <p>UI-006-i9300</p>
59	Verify that the height of data entered does not exceed the height of the fields	Passed	

Document Title:	Test Report	 we test your mobile apps ■
Document ID:	AU0001.000001.212	

	on the screens with text boxes.		
60	Verify that the data entered is not cut with the borders of text boxes.	Passed	
61	Verify that there is no grammar or spelling errors in the screen content.	Passed	
62	Verify that screens do not use different color sets (header colors, body background colors, screen background color, footer colors, etc.).	Passed	
63	Verify that links (e.g. Save as Spreadsheet, Export, Print, Email, etc.) have consistent spacing between them and other UI elements.	Passed	
64	Verify that the dimensions of the buttons and images are the same through all the screens.	Passed	

Table 3 Build Acceptance Testing

81	Verify that user is able to perform clear install from SD card.	Passed	
82	Verify that user is able to perform clear install from Play Market.	Passed	
83	Verify that user is able to start application from desktop.	Passed	
84	Verify that once started, the application is shown in the task manager.	Passed	
85	Verify that home/default screen appears on initial run of the application.	Passed	
86	Verify that application disappears from the task manager list when exited.	Passed	
87	Verify that user is able to uninstall application from device.	Passed	

Table 4 Negative Testing

91	Verify if application is not crashed while trying to call non-existing contact.	Passed	
92	Verify that expected message about non-existing user is shown.	Passed	
93	Verify that application is responsive even after closing the Wi-Fi services in the device.	Passed	
94	Verify that expected message about disabled device capability appears on application start: Wi-Fi is not in range.	Passed	

Document Title:	Test Report	 we test your mobile apps ■
Document ID:	AU0001.000001.212	

Table 5 Compatibility Testing

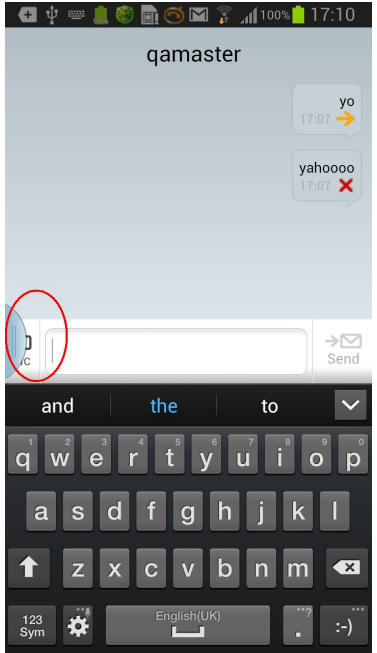
100	Verify that application UI is not affected by device regional settings.	Passed	
101	Verify that there is no overlapping of device UI element in chat with other user.	Failed: Expected result: Image source folder is opened. Actual result: Samsung Touch Wiz side panel is opened due to Touch Wiz button overlapping the "Pic" button.	COMP-001-i9300 

Table 6 System Testing

108	Verify that any active timers, user interface updates or non-critical processing activities are halted by the application while running under locked screen.	Passed	
109	Verify that while the application is running in background, all device buttons behave normally.	Passed	
110	Verify that while the application is running in background, all basic device functions (call, text messaging, etc.) behave normally.	Passed	
111	Verify that while the application is running, the user is able to answer to incoming text message.	Passed	
112	Verify that while the application is running, the user is able to answer the incoming call.	Passed	